



Leicester
City Council

LICENSING (HEARINGS) SUB-COMMITTEE

DATE: THURSDAY, 5 JANUARY 2017

TIME: 9:30 am

PLACE: Meeting Room G.01, Ground Floor, City Hall, 115 Charles Street, Leicester, LE1 1FZ

Members of the Sub-Committee

Councillors Hunter, Thomas and Shelton

Members of the Sub-Committee are summoned to attend the above meeting to consider the items of business listed overleaf.

for Monitoring Officer

Officer contact: Graham Carey
Democratic Support
Leicester City Council
City Hall, 115 Charles Street, Leicester, LE1 1FZ
Tel: 0116 454 6356
E-mail graham.carey@leicester.gov.uk

Information for members of the public

Attending meetings and access to information

You have the right to attend formal meetings such as full Council, committee meetings & Scrutiny Commissions and see copies of agendas and minutes. On occasion however, meetings may, for reasons set out in law, need to consider some items in private.

Dates of meetings and copies of public agendas and minutes are available on the Council's website at www.cabinet.leicester.gov.uk, from the Council's Customer Service Centre or by contacting us using the details below.

Making meetings accessible to all

Wheelchair access – Public meeting rooms at the City Hall are accessible to wheelchair users. Wheelchair access to City Hall is from the middle entrance door on Charles Street - press the plate on the right hand side of the door to open the door automatically.

Braille/audio tape/translation - If you require this please contact the Democratic Support Officer (production times will depend upon equipment/facility availability).

Induction loops - There are induction loop facilities in City Hall meeting rooms. Please speak to the Democratic Support Officer using the details below.

Filming and Recording the Meeting - The Council is committed to transparency and supports efforts to record and share reports of proceedings of public meetings through a variety of means, including social media. In accordance with government regulations and the Council's policy, persons and press attending any meeting of the Council open to the public (except Licensing Sub Committees and where the public have been formally excluded) are allowed to record and/or report all or part of that meeting. Details of the Council's policy are available at www.leicester.gov.uk or from Democratic Support.

If you intend to film or make an audio recording of a meeting you are asked to notify the relevant Democratic Support Officer in advance of the meeting to ensure that participants can be notified in advance and consideration given to practicalities such as allocating appropriate space in the public gallery etc.

The aim of the Regulations and of the Council's policy is to encourage public interest and engagement so in recording or reporting on proceedings members of the public are asked:

- ✓ to respect the right of others to view and hear debates without interruption;
- ✓ to ensure that the sound on any device is fully muted and intrusive lighting avoided;
- ✓ where filming, to only focus on those people actively participating in the meeting;
- ✓ where filming, to (via the Chair of the meeting) ensure that those present are aware that they may be filmed and respect any requests to not be filmed.

Further information

If you have any queries about any of the above or the business to be discussed, please contact Anita James/ Ayleena Thomas, **Democratic Support on (0116) 454 6356 or email graham.carey@leicester.gov.uk** or call in at City Hall, 115 Charles Street.

For Press Enquiries - please phone the **Communications Unit on 0116 454 4151**

PUBLIC SESSION

AGENDA

FIRE/EMERGENCY EVACUATION

If the emergency alarm sounds, you must evacuate the building immediately by the nearest available fire exit and proceed to area outside the Ramada Encore Hotel on Charles Street as Directed by Democratic Services staff. Further instructions will then be given.

1. APPOINTMENT OF CHAIR

2. APOLOGIES FOR ABSENCE

3. DECLARATIONS OF INTEREST

Members are asked to declare any interests they may have in the business to be discussed.

4. MINUTES OF PREVIOUS MEETINGS

The Minutes of the meetings of the Sub-Committee held on 19 August 2016, 14 October 2016 and 28 October 2016 have been circulated and the Sub-Committee is asked to confirm them as a correct record.

The minutes can be found on the Council's website at the following link:-

<http://www.cabinet.leicester.gov.uk:8071/ieListMeetings.aspx?CId=785&Year=0>

5. APPLICATION FOR A VARIATION OF AN EXISTING PREMISES LICENCE, QUALITY SUPERSTORE, 52-54 CATHERINE STREET, LEICESTER **Appendix A**

The Director of Neighbourhood and Environmental Services submits a report on an application for a variation of an existing premises licence for Quality Superstore, 52-54 Catherine Street, Leicester.

Report attached. A copy of the associated documentation is attached for Members only. Further copies are available on the Council's website at www.Cabinet.leicester.gov.uk or by telephoning Democratic Support on 0116 4546356.

(Wards Affected: Belgrave)

6. ANY OTHER URGENT BUSINESS



Leicester
City Council

WARDS AFFECTED
Belgrave

FORWARD TIMETABLE OF CONSULTATION AND MEETINGS:
Hearing under the Licensing Act 2003

5th January 2017

Application for a variation of an existing premises licence
Quality Superstore, 52-54 Catherine Street, Leicester

Report of the Director of Neighbourhood and Environmental Services

1. Purpose of Report

- 1.1. This report provides information for Members about an application made under the Licensing Act 2003, to assist them in determining the outcome of that application.

2. Determination to be made

- 2.1. Having considered the application and representation, Members must consider whether to
- Grant the licence without modification
 - Modify the conditions of the licence
 - Reject the whole application

3. Summary

- 3.1 This report outlines an application for a variation to an existing premises licence for Quality Superstore and summarises the representations received. It also highlights the licensing objectives, the relevant parts of the guidance and regulations, and the pertinent sections of the Licensing Authority's Licensing Policy.

4. Location Plan

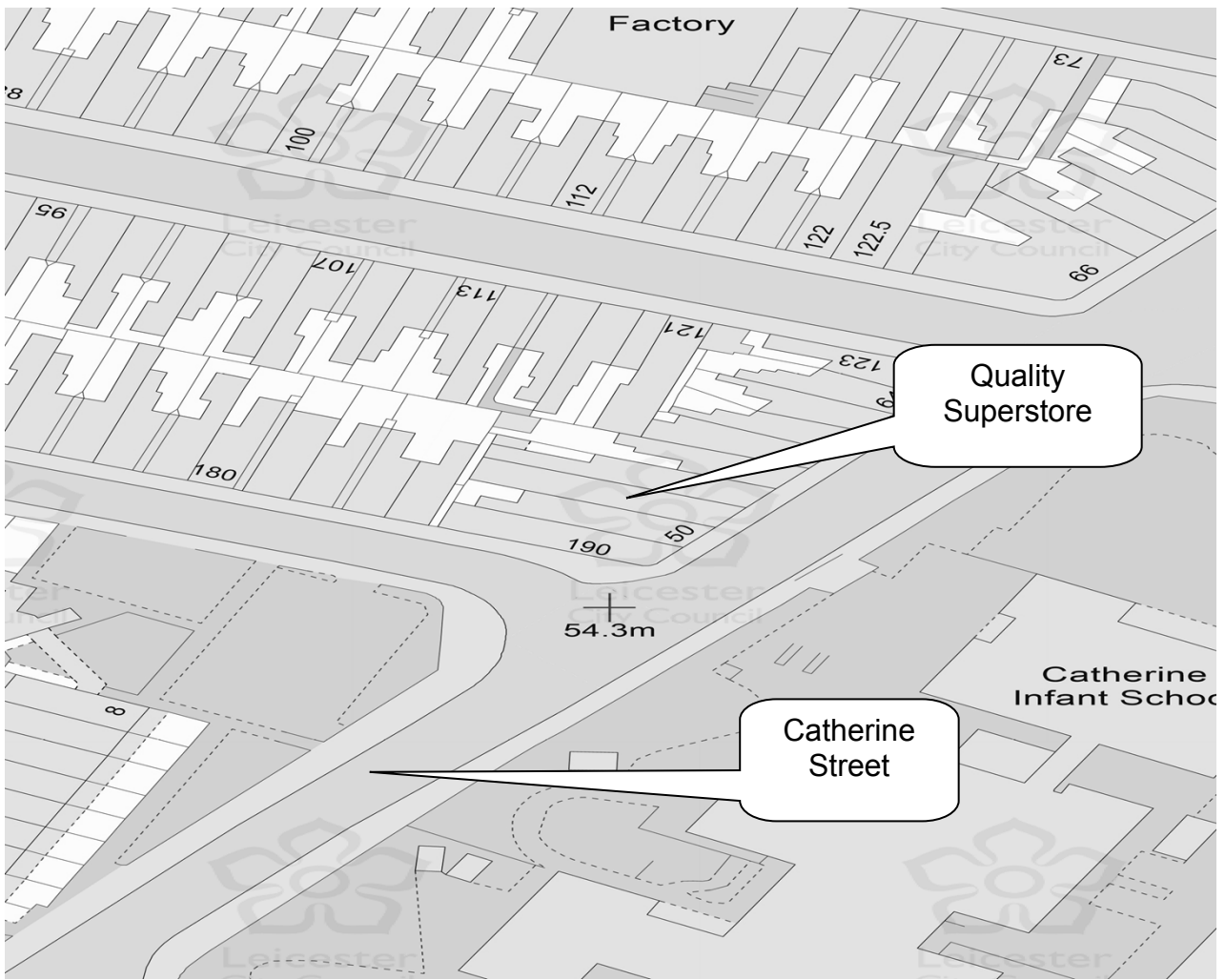

5. Existing Licence

5.1. The existing licence is attached at Appendix A.

6. Application

6.1 An application was received on 8th November 2016 from Quality Superstore Ltd for a variation to an existing premises licence for Quality Superstore. A copy of the application is attached at Appendix B.

6.2 The variation sought by the application is as follows:

Licensable activity	Current Hours	Proposed Hours
Supply of Alcohol & Opening Hours	Mon - Sat 08.00 – 22.00 Sun 10.00 – 20.00	Mon – Sun 06.00 – 01.00

7. Steps to Promote the Licensing Objectives

- 7.1 The steps the applicant proposes to take to promote the licensing objectives are set out in the operating schedule (see section M of Appendix B).
- 7.2 In arriving at its decision on the application, the Licensing Authority's primary consideration must be the promotion of the licensing objectives.

8. Representation

- 8.1 A representation was received on 6th December 2016 from Leicestershire Police. The representation relates to the prevention of crime and disorder and the prevention of public nuisance. Leicestershire Police are concerned that the area suffers from street drinking which is causing anti-social behaviour, noise and litter problems. A copy of the representation is attached at Appendix C.

9. Conditions

- 9.1 The conditions that are consistent with the operating schedule are attached at Appendix D.

10. Statutory Guidance

- 10.1 Any decision made by the Licensing Authority must be in accordance with the licensing objectives. In addition, the government has issued guidance under section 182 of the Licensing Act 2003. The parts of the guidance that are particularly relevant in this case are as follows:

Section	Heading
1.2 – 1.5	Licensing objectives and aims
1.15	General Principles
1.16	Each application on its own merits
2.1 – 2.5	Crime & Disorder
2.14 – 2.20	Public nuisance
8.33 – 8.41	Steps to promote the licensing objectives
9.12	Representations from the Police
9.30 – 9.40	Hearings
9.41 – 9.43	Determining actions that are appropriate for the promotion of the licensing objectives
10.1 – 10.3	Conditions - general
10.8 – 10.9	Imposed conditions
10.27 – 10.68	Mandatory conditions in relation to the supply of alcohol
13.44 – 13.45	Licensing Hours

11. Statement of Licensing Policy

- 11.1 The relevant parts of the Licensing Authority's Statement of Licensing Policy are as follows:

Section	Heading
2	Fundamental Principles
5	Licensing Hours
7	Prevention of Crime and Disorder
9	Prevention of Public Nuisance
11.4 – 11.5	Planning
12	Duplication
13	Standardised conditions

12. Points for Clarification

12.1 The applicant and the party / parties making the representation have been asked to clarify certain points at the hearing, as follows:

By the applicant

1. Whether the applicant considers that the concerns outlined in the representations are valid, and if not why not?
2. In the light of the representations made, does the applicant wish to propose any additional steps for the promotion of the licensing objectives?

By the party making the representation

1. Whether they have any additional information to support the representation they have made?
2. Whether there are any additional steps that could be taken which would be equally effective in the promotion of the licensing objectives?

13. Other Implications

OTHER IMPLICATIONS	YES/ NO	Paragraph/References Within Supporting information
Equal Opportunities	No	
Policy	No	
Sustainable and Environmental	No	
Crime and Disorder	Yes	8.1 – police representation is partly based on concerns about crime and disorder
Human Rights Act	No	
Elderly/People on Low Income	No	
Corporate Parenting	No	
Health Inequalities Impact	No	

14. Background Papers – Local Government Act 1972

14.1 None.

15. Consultations

15.1 The Licensing Authority is not obliged to consult any parties with regard to applications made under the Licensing Act 2003. However, the applicant is required to consult with the responsible authorities as set out in the 2003 Act.

16. Report Author

Amy Day
Licensing Officer
0116 454 3054
Amy.day@leicester.gov.uk

APPENDIX	CONTENT
A	Existing licence
B	Application
C	Representation
D	Conditions consistent with application

Licensing Act 2003
Premises Licence

LEIPRM1277



Leicester
City Council

Local Services & Enforcement
 Leicester City Council
 York House
 91 Granby Street
 Leicester
 LE1 6FB

(0116) 4543040
licensing@leicester.gov.uk

Part 1 - Premises Details

POSTAL ADDRESS OF PREMISES, OR IF NONE, ORDNANCE SURVEY MAP REFERENCE OR DESCRIPTION

Quality Superstore

52 - 54 Catherine Street, Leicester, LE4 6BB.

WHERE THE LICENCE IS TIME LIMITED THE DATES

Not applicable

Expires **no expiry**

LICENSABLE ACTIVITIES AUTHORISED BY THE LICENCE

- the supply of alcohol

THE TIMES THE LICENCE AUTHORISES THE CARRYING OUT OF LICENSABLE ACTIVITIES

Activity (and Area if applicable)	Description	Time From	Time To
J. Supply of alcohol for consumption OFF the premises only	Mon-Sat	8:00am	10:00pm
	Sunday	10:00am	8:00pm

THE OPENING HOURS OF THE PREMISES

Description	Time From	Time To
Mon-Sat	8:00am	10:00pm
Sunday	10:00am	8:00pm

WHERE THE LICENCE AUTHORISES SUPPLIES OF ALCOHOL WHETHER THESE ARE ON AND / OR OFF SUPPLIES

- J. Supply of alcohol for consumption OFF the premises only

Part 2

NAME, (REGISTERED) ADDRESS, TELEPHONE NUMBER AND EMAIL (WHERE RELEVANT) OF HOLDER OF PREMISES LICENCE

Quality Superstore Leicester Ltd

Desai House, 9-13 Holbrook Lane, Coventry, CV6 4AD.

REGISTERED NUMBER OF HOLDER, FOR EXAMPLE COMPANY NUMBER, CHARITY NUMBER (WHERE APPLICABLE)

Quality Superstore Leicester Ltd

8871373



Licensing Act 2003

Premises Licence

LEIPRM1277



Leicester
City Council

Local Services & Enforcement
Leicester City Council
York House
91 Granby Street
Leicester
LE1 6FB

(0116) 4543040
licensing@leicester.gov.uk

NAME, ADDRESS AND TELEPHONE NUMBER OF DESIGNATED PREMISES SUPERVISOR WHERE THE PREMISES LICENCE AUTHORISES THE SUPPLY OF ALCOHOL

Manmeet Singh KHANEJA

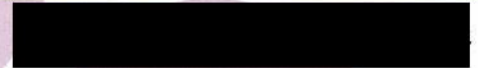

PERSONAL LICENCE NUMBER AND ISSUING AUTHORITY OF PERSONAL LICENCE HELD BY DESIGNATED PREMISES SUPERVISOR WHERE THE PREMISES LICENCE AUTHORISES FOR THE SUPPLY OF ALCOHOL

Licence No. LEIPRS3611

Issued by Leicester

ANNEXES

Annex 1 - Mandatory conditions

No supply of alcohol may be made under the premises licence -

- a) at a time when there is no designated premises supervisor in respect of the premises licence, or
- b) at a time when the designated premises supervisor does not hold a personal licence or his personal licence is suspended.

Every supply of alcohol under the premises licence must be made or authorised by a person who holds a personal licence.

The premises licence holder or club premises certificate holder must ensure that an age verification policy is adopted in respect of the premises in relation to the sale or supply of alcohol.

The designated premises supervisor in relation to the premises licence must ensure that the supply of alcohol at the premises is carried on in accordance with the age verification policy.

The policy must require individuals who appear to the responsible person to be under 18 years of age (or such older age as may be specified in the policy) to produce on request, before being served alcohol, identification bearing their photograph, date of birth and either-

- a) a holographic mark, or
- b) an ultraviolet feature.

A relevant person shall ensure that no alcohol is sold or supplied for consumption on or off the premises for a price which is less than the permitted price.

Annex 2 - Conditions consistent with the operating schedule

The licence holder will ensure that proof of age is requested when necessary e.g passport, driving licence or citizen card

The licence holder will ensure that they have a refusal book.

The licence holder will ensure that children are restricted on the premises

The licence holder will ensure Health and Safety is complied with at all times

The licence holder will ensure that rubbish bins and glass refuse are kept at the rear of the premises

The licence holder will ensure that windows and doors will be closed if it causes too much nuisance

Annex 3 - Conditions attached after a hearing by the Licensing Authority

None



Portugal Mini Market
52-54 Catherine Street
Leicester
LE4 6BB

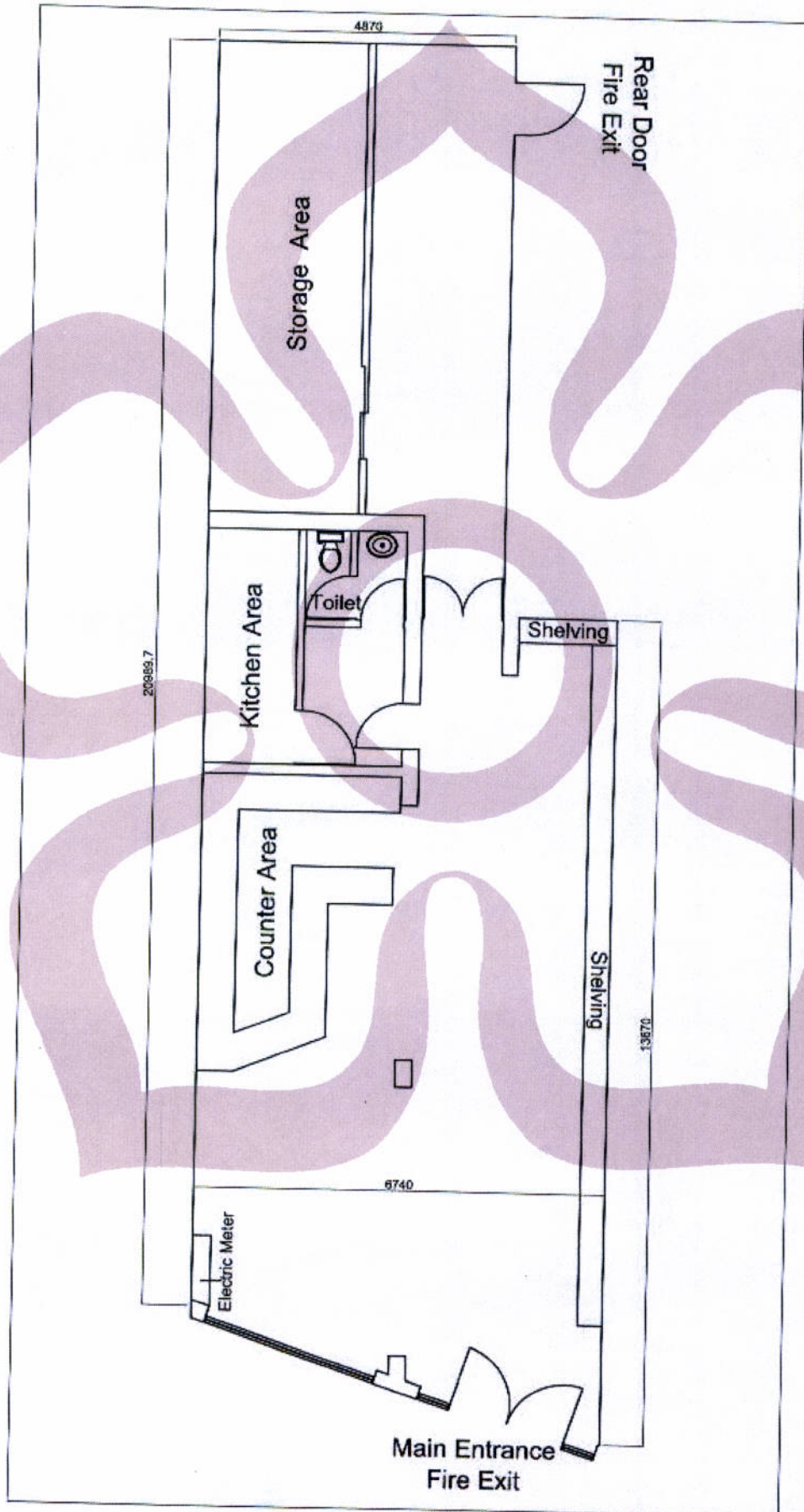

Plan
Scale 1/100



Leicester
City Council

Local Services & Enforcement
Leicester City Council
York House
91 Granby Street
Leicester
LE1 6FB

(0116) 4543040
licensing@leicester.gov.uk

Premises Details

POSTAL ADDRESS OF PREMISES, OR IF NONE, ORDNANCE SURVEY MAP REFERENCE OR DESCRIPTION

Quality Superstore

52 - 54 Catherine Street, Leicester, LE4 6BB.

WHERE THE LICENCE IS TIME LIMITED THE DATES

Not applicable

LICENSABLE ACTIVITIES AUTHORISED BY THE LICENCE

- the supply of alcohol

THE TIMES THE LICENCE AUTHORISES THE CARRYING OUT OF LICENSABLE ACTIVITIES

Activity (and Area if applicable)	Description	Time From	Time To
J. Supply of alcohol for consumption OFF the premises only	Mon-Sat	8:00am	10:00pm
	Sunday	10:00am	8:00pm

THE OPENING HOURS OF THE PREMISES

Description	Time From	Time To
Mon-Sat	8:00am	10:00pm
Sunday	10:00am	8:00pm

WHERE THE LICENCE AUTHORISES SUPPLIES OF ALCOHOL WHETHER THESE ARE ON AND / OR OFF SUPPLIES

- J. Supply of alcohol for consumption OFF the premises only

NAME, (REGISTERED) ADDRESS OF HOLDER OF PREMISES LICENCE

Quality Superstore Leicester Ltd

Desai House, 9-13 Holbrook Lane, Coventry, CV6 4AD.

REGISTERED NUMBER OF HOLDER, FOR EXAMPLE COMPANY NUMBER, CHARITY NUMBER (WHERE APPLICABLE)

Quality Superstore Leicester Ltd

8871373

NAME OF DESIGNATED PREMISES SUPERVISOR WHERE THE PREMISES LICENCE AUTHORISES THE SUPPLY OF ALCOHOL

Manmeet Singh KHANEJA



Licensing Act 2003

Premises Licence Summary

LEIPRM1277



Leicester
City Council

Local Services & Enforcement
Leicester City Council
York House
91 Granby Street
Leicester
LE1 6FB

(0116) 4543040
licensing@leicester.gov.uk

STATE WHETHER ACCESS TO THE PREMISES BY CHILDREN IS RESTRICTED OR PROHIBITED



Appendix B



Application to vary a premises licence under the Licensing Act 2003

PLEASE READ THE FOLLOWING INSTRUCTIONS FIRST

Before completing this form please read the guidance notes at the end of the form. If you are completing this form by hand please write legibly in block capitals. In all cases ensure that your answers are inside the boxes and written in black ink. Use additional sheets if necessary.

You may wish to keep a copy of the completed form for your records.

I/We ~~Manmeet Singh Khareja~~ QUALITY SUPERSTORE LEICESTER LTD
(Insert name(s) of applicant)

being the premises licence holder, apply to vary a premises licence under section 34 of the Licensing Act 2003 for the premises described in Part 1 below

Premises licence number
LEIPRM1277

Part 1 – Premises Details

Postal address of premises or, if none, ordnance survey map reference or description 52 – 54 Catherine Street Leicester			
Post town	Leicester	Postcode	LE4 6BB
Telephone number at premises (if any)	[REDACTED]		
Non-domestic rateable value of premises	£5,600		

CUSTOMER SERVICE CENTRE
91 GRANBY STREET
- 7 NOV 2016
RECEIVED

Part 2 – Applicant details

Daytime contact telephone number		[REDACTED]	
E-mail address (optional)			
Current postal address if different from premises address			
Post town		Postcode	

Part 3 - Variation

Please tick as appropriate

Do you want the proposed variation to have effect as soon as possible? Yes

If not, from what date do you want the variation to take effect?

DD	MM	YYYY
⊥	⊥	⊥
⊥	⊥	⊥
⊥	⊥	⊥

Do you want the proposed variation to have effect in relation to the introduction of the late night levy?
 (Please see guidance note 1) Yes No

Please describe briefly the nature of the proposed variation (Please see guidance note 2)

Extend opening and closing times.

Current:

8:00am – 10:00pm Mon – Sat

10:00am – 8:00pm Sun

New:

06:00am – 01:00am Mon – Sun.

If your proposed variation would mean that 5,000 or more people are expected to attend the premises at any one time, please state the number expected to attend:

Part 4 Operating Schedule

Please complete those parts of the Operating Schedule below which would be subject to change if this application to vary is successful.

Provision of regulated entertainment**Please tick all that apply**

- | | |
|--|--------------------------|
| a) plays (if ticking yes, fill in box A) | <input type="checkbox"/> |
| b) films (if ticking yes, fill in box B) | <input type="checkbox"/> |
| c) indoor sporting events (if ticking yes, fill in box C) | <input type="checkbox"/> |
| d) boxing or wrestling entertainment (if ticking yes, fill in box D) | <input type="checkbox"/> |
| e) live music (if ticking yes, fill in box E) | <input type="checkbox"/> |
| f) recorded music (if ticking yes, fill in box F) | <input type="checkbox"/> |
| g) performances of dance (if ticking yes, fill in box G) | <input type="checkbox"/> |
| h) anything of a similar description to that falling within (e), (f) or (g)
(if ticking yes, fill in box H) | <input type="checkbox"/> |

Provision of late night refreshment (if ticking yes, fill in box I)

Supply of alcohol (if ticking yes, fill in box J)

Y

In all cases complete boxes K, L and M

A

Plays Standard days and timings (please read guidance note 7)			<u>Will the performance of a play take place indoors or outdoors or both – please tick</u> (please read guidance note 3)	Indoors <input type="checkbox"/>
				Outdoors <input type="checkbox"/>
Day	Start	Finish		Both <input type="checkbox"/>
Mon			<u>Please give further details here</u> (please read guidance note 4)	
Tue				
Wed			<u>State any seasonal variations for performing plays</u> (please read guidance note 5)	
Thur				
Fri			<u>Non standard timings. Where you intend to use the premises for the performance of plays at different times to those listed in the column on the left, please list</u> (please read guidance note 6)	
Sat				
Sun				

B

Films Standard days and timings (please read guidance note 7)			<u>Will the exhibition of films take place indoors or outdoors or both – please tick</u> (please read guidance note 3)	Indoors	<input type="checkbox"/>
				Outdoors	<input type="checkbox"/>
				Both	<input type="checkbox"/>
Day	Start	Finish	<u>Please give further details here</u> (please read guidance note 4)		
Mon					
Tue					
Wed			<u>State any seasonal variations for the exhibition of films</u> (please read guidance note 5)		
Thur					
Fri					
Sat					
Sun					
			<u>Non standard timings. Where you intend to use the premises for the exhibition of films at different times to those listed in the column on the left, please list</u> (please read guidance note 6)		

C

Indoor sporting events Standard days and timings (please read guidance note 7)			<u>Please give further details</u> (please read guidance note 4)
Day	Start	Finish	
Mon			<u>State any seasonal variations for indoor sporting events</u> (please read guidance note 5)
Tue			
Wed			<u>Non standard timings. Where you intend to use the premises for indoor sporting events at different times to those listed in the column on the left, please list</u> (please read guidance note 6)
Thur			
Fri			
Sat			
Sun			

D

Boxing or wrestling entertainments Standard days and timings (please read guidance note 7)			<u>Will the boxing or wrestling entertainment take place indoors or outdoors or both – please tick</u> (please read guidance note 3)	Indoors	<input type="checkbox"/>
				Outdoors	<input type="checkbox"/>
				Both	<input type="checkbox"/>
Day	Start	Finish	<u>Please give further details here</u> (please read guidance note 4)		
Mon					
Tue			<u>State any seasonal variations for boxing or wrestling entertainment</u> (please read guidance note 5)		
Wed					
Thur			<u>Non standard timings. Where you intend to use the premises for boxing or wrestling entertainment at different times to those listed in the column on the left, please list</u> (please read guidance note 6)		
Fri					
Sat					
Sun					

E

Live music Standard days and timings (please read guidance note 7)			Will the performance of live music take place indoors or outdoors or both – please tick (please read guidance note 3)	Indoors	<input type="checkbox"/>			
				Outdoors	<input type="checkbox"/>			
				Both	<input type="checkbox"/>			
Day	Start	Finish	Please give further details here (please read guidance note 4)					
Mon								
Tue								
Wed						State any seasonal variations for the performance of live music (please read guidance note 5)		
Thur								
Fri						Non standard timings. Where you intend to use the premises for the performance of live music at different times to those listed in the column on the left, please list (please read guidance note 6)		
Sat								
Sun								

F

Recorded music Standard days and timings (please read guidance note 7)			Will the playing of recorded music take place indoors or outdoors or both – please tick (please read guidance note 3)	Indoors	<input type="checkbox"/>
				Outdoors	<input type="checkbox"/>
				Both	<input type="checkbox"/>
Day	Start	Finish	Please give further details here (please read guidance note 4)		
Mon					
Tue					
Wed					
Thur					
Fri					
Sat					
Sun					
			State any seasonal variations for the playing of recorded music (please read guidance note 5)		
			Non standard timings. Where you intend to use the premises for the playing of recorded music at different times to those listed in the column on the left, please list (please read guidance note 6)		

G

Performances of dance Standard days and timings (please read guidance note 7)			<u>Will the performance of dance take place indoors or outdoors or both – please tick</u> (please read guidance note 3)	Indoors	<input type="checkbox"/>			
				Outdoors	<input type="checkbox"/>			
				Both	<input type="checkbox"/>			
Day	Start	Finish	<u>Please give further details here</u> (please read guidance note 4)					
Mon								
Tue								
Wed						<u>State any seasonal variations for the performance of dance</u> (please read guidance note 5)		
Thur								
Fri								
Sat						<u>Non standard timings. Where you intend to use the premises for the performance of dance at different times to those listed in the column on the left, please list</u> (please read guidance note 6)		
Sun								

H

<p>Anything of a similar description to that falling within (e), (f) or (g) Standard days and timings (please read guidance note 7)</p>			<p>Please give a description of the type of entertainment you will be providing</p>		
Day	Start	Finish	<p><u>Will this entertainment take place indoors or outdoors or both – please tick</u> (please read guidance note 3)</p>	Indoors	<input type="checkbox"/>
Mon				Outdoors	<input type="checkbox"/>
				Both	<input type="checkbox"/>
Tue			<p><u>Please give further details here</u> (please read guidance note 4)</p>		
Wed					
Thur			<p><u>State any seasonal variations for entertainment of a similar description to that falling within (e), (f) or (g)</u> (please read guidance note 5)</p>		
Fri					
Sat			<p><u>Non standard timings. Where you intend to use the premises for the entertainment of a similar description to that falling within (e), (f) or (g) at different times to those listed in the column on the left, please list</u> (please read guidance note 6)</p>		
Sun					

I

Late night refreshment Standard days and timings (please read guidance note 7)			Will the provision of late night refreshment take place indoors or outdoors or both – please tick (please read guidance note 3)	Indoors	<input type="checkbox"/>
				Outdoors	<input type="checkbox"/>
				Both	<input type="checkbox"/>
Day	Start	Finish	Please give further details here (please read guidance note 4)		
Mon					
Tue			State any seasonal variations for the provision of late night refreshment (please read guidance note 5)		
Wed					
Thur			Non standard timings. Where you intend to use the premises for the provision of late night refreshment at different times, to those listed in the column on the left, please list (please read guidance note 6)		
Fri					
Sat					
Sun					

J

Supply of alcohol Standard days and timings (please read guidance note 7)			Will the supply of alcohol be for consumption – please tick (please read guidance note 8)	On the premises	
				Off the premises	Y
				Both	
Day	Start	Finish	State any seasonal variations for the supply of alcohol (please read guidance note 5)		
Mon	06:00	01:00			
	AM	AM			
Tue	06:00	01:00			
	AM	AM			
Wed	06:00	01:00			
	AM	AM			
Thur	06:00	01:00			
	AM	AM			
Fri	06:00	01:00			
	AM	AM			
Sat	06:00	01:00			
	AM	AM			
Sun	06:00	01:00			
	AM	AM			
			Non-standard timings. Where you intend to use the premises for the supply of alcohol at different times to those listed in the column on the left, please list (please read guidance note 6)		

K

Please highlight any adult entertainment or services, activities, other entertainment or matters ancillary to the use of the premises that may give rise to concern in respect of children (please read guidance note 9).
NA

L

Hours premises are open to the public Standard days and timings (please read guidance note 7)			State any seasonal variations (please read guidance note 5) NA
Day	Start	Finish	Non standard timings. Where you intend the premises to be open to the public at different times from those listed in the column on the left, please list (please read guidance note 6) NA
Mon	06:00	01:00	
	AM	AM	
Tue	06:00	01:00	
	AM	AM	
Wed	06:00	01:00	
	AM	AM	
Thur	06:00	01:00	
	AM	AM	
Fri	06:00	01:00	
	AM	AM	
Sat	06:00	01:00	
	AM	AM	
Sun	06:00	01:00	
	AM	AM	

Please identify those conditions currently imposed on the licence which you believe could be removed as a consequence of the proposed variation you are seeking.

Please tick as appropriate

- I have enclosed the premises licence
- I have enclosed the relevant part of the premises licence

Y

If you have not ticked one of these boxes, please fill in reasons for not including the licence or part of it below

Reasons why I have not enclosed the premises licence or relevant part of premises licence.

M

Describe any additional steps you intend to take to promote the four licensing objectives as a result of the proposed variation:

a) General – all four licensing objectives (b, c, d and e) (please read guidance note 10)

b) The prevention of crime and disorder

Not supply to minors,
Regulate the amount of alcohol supplied to one person,
Regularly check ID to ensure no alcohol is supplied to minors,
Installed CCTV cameras to deter any possible criminal incidents.

c) Public safety

Not supply to minors,
Regulate the amount of alcohol supplied to one person.

d) The prevention of public nuisance

Regulate the amount of alcohol supplied to one person,
Ensure no drinking of alcohol takes place outside/inside the premises.

e) The protection of children from harm

--

Checklist:**Please tick to indicate agreement**

- | | |
|---|--|
| <ul style="list-style-type: none"> • I have made or enclosed payment of the fee; or
I have not made or enclosed payment of the fee because this application has been made in relation to the introduction of the late night levy. • I have sent copies of this application and the plan to responsible authorities and others where applicable. • I understand that I must now advertise my application. • I have enclosed the premises licence or relevant part of it or explanation. • I understand that if I do not comply with the above requirements my application will be rejected. | <p>Y</p> <p>N</p> <p>Y</p> <p>Y</p> <p>Y</p> |
|---|--|

IT IS AN OFFENCE, LIABLE ON SUMMARY CONVICTION TO A FINE NOT EXCEEDING LEVEL 5 ON THE STANDARD SCALE, UNDER SECTION 158 OF THE LICENSING ACT 2003, TO MAKE A FALSE STATEMENT IN OR IN CONNECTION WITH THIS APPLICATION.

Part 5 – Signatures (please read guidance note 11)

Signature of applicant (the current premises licence holder) or applicant's solicitor or other duly authorised agent (please read guidance note 12). **If signing on behalf of the applicant, please state in what capacity.**

Signature	[REDACTED]
Date	7/11/16
Capacity	Premises Licence holder

Where the premises licence is jointly held, signature of 2nd applicant (the current premises licence holder) or 2nd applicant's solicitor or other authorised agent (please read guidance note 13). **If signing on behalf of the applicant, please state in what capacity.**

Signature	
Date	
Capacity	

Contact name (where not previously given) and address for correspondence associated with this application (please read guidance note 14)

Post town		Post code	
Telephone number (if any)			
If you would prefer us to correspond with you by e-mail, your e-mail address (optional)			



Leicestershire Police

Appendix C

Licensing Act 2003 – Representation in respect of Premises Licence Major Variation Application

Details of person or body making representation	
Your Name:	PC Jonathan Webb
Your Address:	Force Licensing Department, Mansfield House, 74 Belgrave Gate, Leicester LE1 3GG

Details of premises representation is about	
Name of Premises:	Quality Superstore
Address of premises:	52 – 54 Catherine Street Leicester LE4 6BB
Application No. (if known)	

Please tick one or more of the licensing objectives that your representation relates to:g	
Prevention of crime and disorder	<input checked="" type="checkbox"/>
Public Safety	<input type="checkbox"/>
Prevention of public nuisance	<input checked="" type="checkbox"/>
Protection of children from harm	<input type="checkbox"/>

Please summarise your concerns about this application:
<p>I write in my capacity as a licensing officer for Leicestershire Police on the authority delegated to me by the Chief Constable.</p> <p>My representation relates to the Licensing Objectives of Prevention Of Crime & Disorder & Prevention of Public Nuisance.</p> <p>This application relates to a shop located in a highly residential area and directly opposite Catherine Infant School.</p> <p>The applicant is looking to substantially vary the present licence in relation to the supply of alcohol. The change would see alcohol available from 6.00am in the morning instead of 8.00am and until 1.00am in the early hours of the morning. These</p>

changes are requested to be available every day of the week.

There are a number of shops on Catherine St with licences to supply alcohol, three of these are in close proximity.

The maximum hours a licence in this area allows for the supply of alcohol at a shop is between 7.00am and midnight.

The area suffers from a high incidence of street drinking carried out by Asian males. Many of these males are employed at factories in the area and will purchase alcohol after finishing their shifts and then drink in groups before heading home. Much of this drinking is carried out on parks and car parks in the vicinity with these large groups causing noise and litter problems which in turn cause distress to local residents.

There have been 6 Sentinel incidents recorded for the Catherine Street area relating to street drinking. Sentinel is the multi-agency anti-social behaviour recording system

Were this variation to be granted it would allow people to obtain alcohol at a time which could have the greatest impact on anti-social behaviour and potentially increase the amount of problems already being experienced.

The applicant has offered two conditions to promote the licensing objectives, CCTV installed and to ensure no drinking takes place outside/inside the premises. The steps put forward on the application do not, in the opinion of Leicestershire Police, sufficiently ensure anti-social behaviour will not occur and that the Licensing Objectives of crime and disorder or preventing public nuisance will be promoted.

Leicestershire Police therefore request that the application to vary the opening hours of this premises is refused.

PC1790 Jonathan Webb
06th December 2016

CONDITIONS CONSISTENT WITH THE OPERATING SCHEDULE

The licence holder will ensure CCTV is installed at the premises.

The licence holder will ensure an age verification policy is in force at the premises.

